

Dash Number:

✓ d	M3	M4	M5	M6	M8	M10	M12
6	001	006					
8	002	007	011				
10	003	008	012	021			
12	004	009	013	022	032		
16	005	010	014	023	033	043	
18			015	024	034	044	
20			016	025	035	045	053
25			017	026	036	046	054
30			018	027	037	047	055
35			019	028	038	048	056
40			020	029	039	049	057
45				030	040	050	058
50				031	041	051	059
60					042	052	060

ON REQUEST

To create the complete part number for normalized item refer to the following table

BLUE Standard								
	Fix	.	Main Group	Subgroup	-	Dash Number	Material *	Treatment *
Generic	SP	.	XX	XXX	-	XXX	X	X
Example	SP	.	01	001	-	111	J	B

Standard Reference	EN ISO 7380-2	Issue Date	26/10/2015
Blue Standard	SP.01010	Rev. Date	26/10/2015
Hexagon Socket Button Head Cap Screw With Flange		Rev.00	Sheet 1 of 2
		-	
All rights reserved. No parts of this document may be reproduced or utilized in any form or by any means, electronic or mechanical, including photocopying and microfilm without permission in write form.			

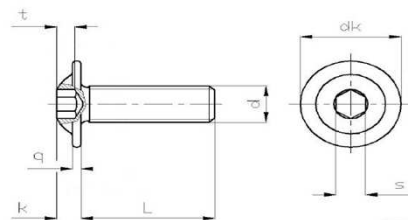

Related Size :

d		M3	M4	M5	M6	M8	M10	M12
dk	min.	6,32	8,82	11,10	12,90	17,10	21,06	25,16
	max.	6,90	9,40	11,80	13,60	17,80	21,90	26,00
s	CH	2	2,5	3	4	5	6	8
k	min.	1,40	1,95	2,50	3,00	4,10	5,20	6,24
	max.	1,65	2,20	2,75	3,30	4,40	5,50	6,60
q	min.	0,55	0,65	0,80	1,00	1,25	1,70	2,10
	max.	0,70	0,80	1,00	1,20	1,50	2,00	2,40
t	min.	1,04	1,30	1,56	2,08	2,60	3,12	4,16
	max.	1,45	1,65	2,12	2,56	3,05	3,75	4,61

Standard Reference -	ISO 7380-2	Issue Date -	26/10/2015
Blue Standard -	SP.01010	Rev. Date -	26/10/2015
Hexagon Socket Button Head Cap Screw With Flange -		Rev.00 -	Sheet 2 of 2
All rights reserved. No parts of this document may be reproduced or utilized in any form or by any means, electronic or mechanical, including photocopying and microfilm without permission in writing from.			